



AC7500

WIRELESS DUAL DIGITAL PRESSURE DISPLAY

INSTALLATION

1. Install display to power socket.
2. Install "L" pressure sensor to Left airbag pressure and install "R" pressure sensor to Right airbag pressure.

The supplied pressure sensors can be installed directly to your inflation valves using the supplied lock nuts. Alternatively, the supplied 1/8" NPT adaptor fittings can be used to install the sensors into 1/8" NPT female fitting on your Air Control system. Ensure suitable sealant is used for leak free connections.



IMPORTANT

*Sensor removal from the adaptor fittings will cause air loss and suspension movement. Ensure no one is near or under the vehicle as they may be trapped or injured.

*When the display has been OFF, where leak down to Ops can occur, turn the system ON and then inflate to immediately update the display and check for pressure loss. Significant pressure loss requires repair to ensure correct system performance.

WARNING

THIS PRODUCT CONTAINS A BUTTON BATTERY

If swallowed, a lithium battery can cause severe or fatal injuries within two hours.

Keep batteries out of reach of children.

If you suspect your child has swallowed or inserted a button battery, immediately call the 24-hour Poisons Information Centre on 13 11 26 (in Australia).

PRESSURE DISPLAY

The wireless dual digital pressure display monitors your Left and Right airbag pressures while driving and during airbag adjustment the display will continually update airbag pressure changes as required.

If a pressure sensor is removed, if a pressure sensor battery is flat, or if pressure is 0 psi for an extended period, a dash -- will display as shown on the Left below. If this Error is not resolved, the display will then show Err as shown on the Right below.

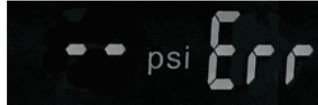

The display unit of measure can be changed between PSI and BAR. To change the display unit Hold the Set button and Right button for 3 seconds and the display will update.

DISPLAY SETTINGS

LEFT BUTTON SET BUTTON RIGHT BUTTON



The display features Low and High pressure alarms. The display is supplied with the Low pressure alarm set at 5psi and the High pressure alarm set at 30psi. These pressure alarms can be set for your application.

SET PRESSURE ALARMS

1. Hold the Set Button for 3 seconds to enter High pressure alarm setting.



2. Press the Left Button and the first digit will be selected.



3. Press the Right Button to increase this digit.

4. Press the Left Button to select the Second digit and the Right Button to increase this digit.



5. Press the Left Button to select the Third digit and the Right Button to increase this digit.

6. To confirm the High pressure alarm setting press the Left button and the display will BEEP.

7. Press the Right Button to enter the Low pressure alarm setting.



8. Follow Steps 2.-6. to set your Low pressure alarm setting. After setting the Third digit confirm the Low pressure alarm setting by pressing the Left button and the display will BEEP.

9. Press the Right button to exit the pressure alarm setting.

Note: Setting your Low pressure alarm to Ops will cause no Low pressure warning. When the alarm sounds, pressing any button on the display will turn off the alarm sound.

RESET PRESSURE ALARM SETTINGS

The display can be returned to the supplied Low pressure alarm and High pressure alarm settings. To reset the display Hold the Right button for 3 seconds and the display will BEEP.

VOLTAGE DISPLAY

Your vehicle voltage to the power outlet can be monitored on the display. In the normal operating screen press the Left Button for voltage display. The display will return to normal operation.



Low vehicle voltage will affect performance of air compressors and other electrical components. It is recommended to always have 12.0 – 14.5volts for best performance.

BATTERY REPLACEMENT

Remove the sensor assembly from the airbag pressure fitting.

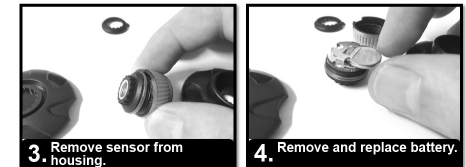
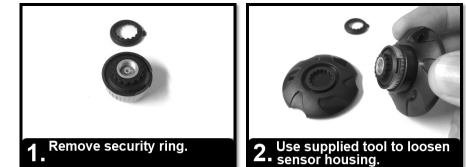

Replace the sensor assembly to the airbag pressure fitting.

PAIRING SENSORS TO DISPLAY

Replacement sensors can be paired to the display if damaged or lost.

1. Keep the L & R sensors separated and follow the Battery replacement process above to remove the sensor batteries from the sensors.
2. Hold the Left Button AND Set Button together for 3 seconds to enter Pairing mode.
3. The display will show the Left sensor ID. Now install the battery into the Left sensor. The display will BEEP when the sensor is paired.
4. Press the Right Button to pair the Right sensor.
5. The display will now show the Right sensor ID. Now install the battery into the Right sensor. The display will BEEP when the sensor is paired.
6. Press the Right Button to exit Pairing mode.