

THE POWER OF

REDARC®

BCDCMB-104

Mounting Bracket for Selected
REDARC BCDC Battery Chargers

SUITABLE FOR TOYOTA HILUX

(03/2005-09/2015)

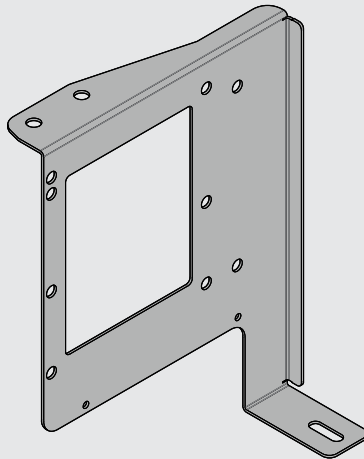

BCDC Alpha Mounting Bracket

Suitable for TOYOTA Hilux

(03/2005–09/2015)

The REDARC **BCDCMB-104** Mounting Bracket is designed to install your BCDC Classic/BCDC Alpha Battery Charger close to an auxiliary battery mounted in the engine bay. Do not use if the battery is located elsewhere.

For maximum performance, mount your BCDC Classic/BCDC Alpha in the cool airflow at the front of your vehicle, away from high temperature areas.

The BCDC Alpha Mounting Bracket is constructed from durable stainless steel and has been designed to fit existing mounting points in your vehicle for ease of installation.

***NOTE:** The BCDC Alpha Mounting Brackets are only for engine bay designed Battery Chargers. DO NOT use the Mounting Bracket to install a BCDC Core Battery Charger (BCDCN1225, BCDCN1240).

WARNINGS AND SAFETY INFORMATION

SAVE THESE INSTRUCTIONS — this manual contains important safety instructions. Do not install the BCDC Alpha Mounting Bracket unless you have read and understood this manual.

REDARC recommends to review your vehicle to ensure this kit suits your vehicle's make and specifications.

REDARC recommends that the BCDC Alpha Mounting Brackets be installed by a suitably qualified person. It is the installers responsibility to ensure their installation complies with any applicable legal and regulatory requirements.

Disclaimer: REDARC accepts no liability for any injury, loss or property damage which may occur from the improper or unsafe installation or use of its products.

SAFETY MESSAGE CONVENTIONS

Safety messages in this manual include a signal word to indicate the level of the hazard as follows:

⚠ WARNING

Indicates a potentially hazardous situation which could result in death or serious injury to the operator or to bystanders.

⚠ CAUTION

Indicates a potentially hazardous situation which may result in moderate or minor injury to the operator or to bystanders.

NOTICE

Indicates a situation that may cause equipment damage.

⚠ WARNING

- Do not operate around the engine bay with the engine operating. Ensure the vehicle is OFF before mounting Battery Charger assembly.

⚠ CAUTION

- Use Personal Protective Equipment (PPE). Wear appropriate clothing as well as eye protection when operating power tools.
- Take care when working in and around engine bay to avoid punch points, sharp edges and hot surfaces.



NOTICE

- Removing existing vehicle fixings may expose bare metal, resulting in rust. Retouch any exposed metal with rust inhibitor if it is not an earth connection.
- Damage to cabling can cause failure of the Battery Charger and vehicle electrical systems. Ensure wiring is clear of sharp edges and moving parts.

BCDC ALPHA MOUNTING BRACKET PARTS

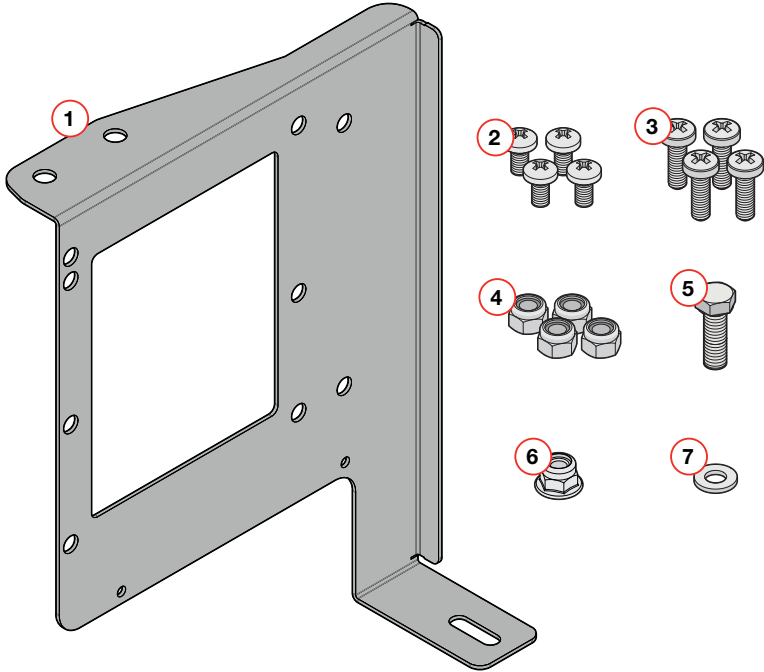

1. Mounting Bracket

Supplied with 1 bracket.

2. M6 x 12mm Pan Head Screw

Supplied with 4 screws.

3. M6 x 20mm Pan Head Screw

Supplied with 4 screws.

4. M6 Nyloc Locking Nut

Supplied with 4 nuts.

5. M6 x 20mm Hex Head Bolt

Supplied with 1 bolt.

6. M6 Flanged Nyloc Locking Nut

Supplied with 1 nut.

7. M6 Flat Washer

Supplied with 1 washer.

RECOMMENDED TOOLS

The tools listed below are typically sufficient to complete the installation, however, some specific models may require more specialised tools.

- Metric Socket set (at least 10 mm and 12 mm socket) with extension bars.
- Metric Spanner 10 mm, 12 mm and 13 mm.
- Medium (#3) Phillips-Head Screwdriver.

ASSEMBLY

ASSEMBLING BATTERY CHARGER TO BRACKET

The BCDC Alpha Mounting Bracket must be fitted to the Battery Charger before mounting to the vehicle. Do not install the BCDC Alpha Mounting Bracket to the vehicle first.

BCDC Classic Battery Charger

If mounting a BCDC Classic Battery Charger, use the supplied M6 × 12 mm Pan Head Bolts and M6 Nyloc Locking Nuts to secure the Battery Charger to the Mounting Bracket (see [Figure 1](#)).

BCDC Alpha Battery Charger

If mounting a BCDC Alpha Battery Charger, use the supplied M6 × 20 mm Pan Head Bolts and M6 Nyloc Locking Nuts to secure the Battery Charger to the Mounting Bracket (see [Figure 2](#)).

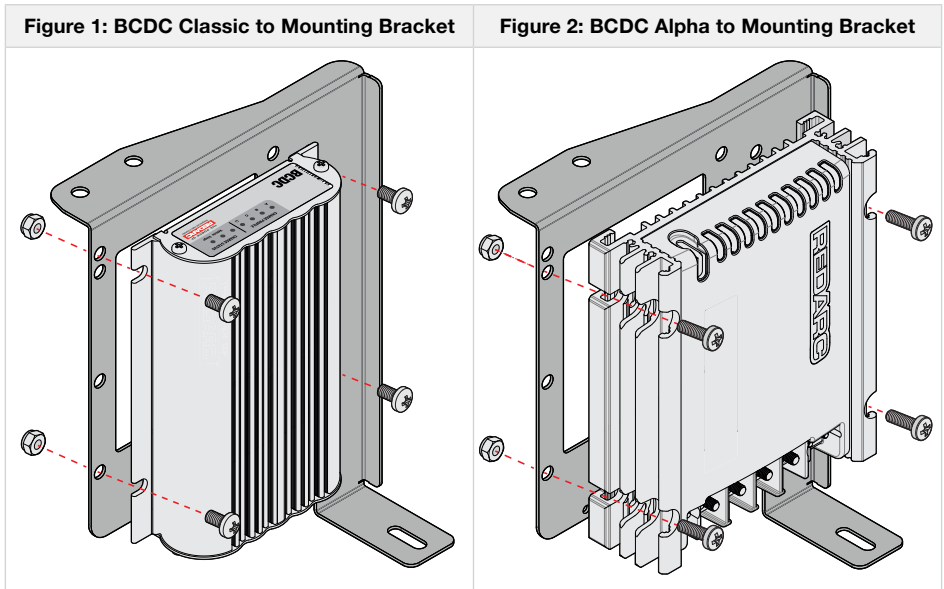

PRIOR TO INSTALLATION

INSTALLATION LOCATION

The assembled Mounting Bracket and Battery Charger will be mounted on the left side of the radiator support panel in the engine bay.

Figure 3: Installation Location

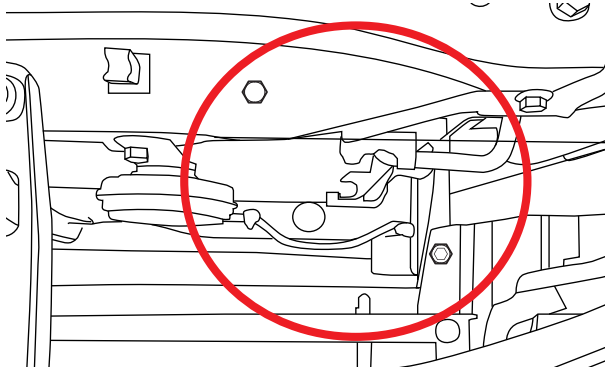

BATTERY CHARGER WIRING

NOTICE: Damage to cabling can cause failure to the Battery Charger and the vehicle's electrical system. Ensure wiring is clear of sharp edges, moving parts and has enough slack to allow for flexing.

Fit the Battery Charger with the wiring connected to the bracket before mounting in the vehicle. It is difficult to access the Battery Charger once the bracket is installed.

Complete the required wiring in accordance with your Battery Charger's instruction manual.

REMOVING VEHICLE FIXINGS

NOTICE: Removing factory fitted screws may expose to sharp surfaces and bare metal, resulting in rust. Retouch any exposed metal with rust inhibitor if it is not an earth connection.

Remove the vehicle fixing on the left side of the radiator bracket and the vehicle fixing holding the lower headlight mount in place (see [Figure 4](#)).

Figure 4: Locations of Vehicle Fixings to be Removed

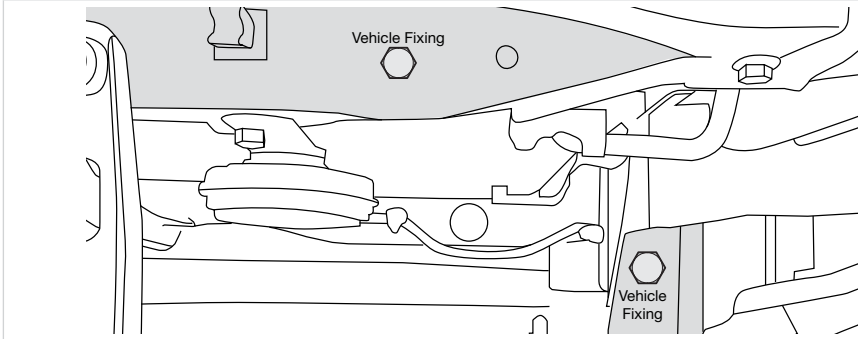

On some vehicles a plastic trim covers the headlight mount which needs to be removed for the installation. If your vehicle has a plastic deflector proceed to [Figure 5](#). If your vehicle does not have this proceed to [page 8](#).

VEHICLES FITTED WITH A PLASTIC TRIM

Remove the plastic trim by removing the two body clips and popping the plastic retainer clips out.

Cut the plastic trim a fraction above the strengthening rib as seen in [Figure 5](#) to allow clearance for the Mounting Bracket assembly.

Figure 5: Cutting Location on the Plastic Trim

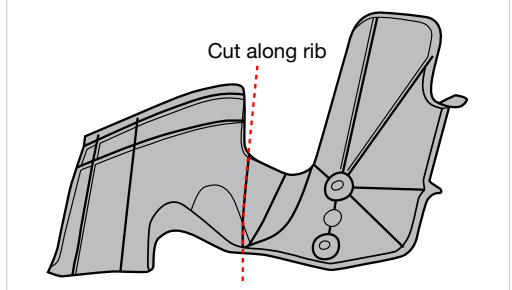

INSTALLATION

FITTING THE MOUNTING BRACKET TO THE VEHICLE

To fit the Mounting Bracket assembly to the vehicle refer to **Figure 6** and adhere to the following steps:

1. Align the top left mounting point to the vehicle fixing hole **(1)** and the bottom mounting point to the vehicle fixing hole **(2)**.
2. Loosely refit the two vehicle fixings **(1) (2)**.
3. Secure the third mounting position with the supplied M6 × 20 mm Hex Bolt, M6 Washer and M6 Flanged Nyloc Locking Nut **(3)**. Tighten to 7.5 Nm (66 in-lb).
4. Tighten vehicle fixings to the vehicle manufacturers torque specifications.

Figure 6: Securing Mounting Bracket to Vehicle

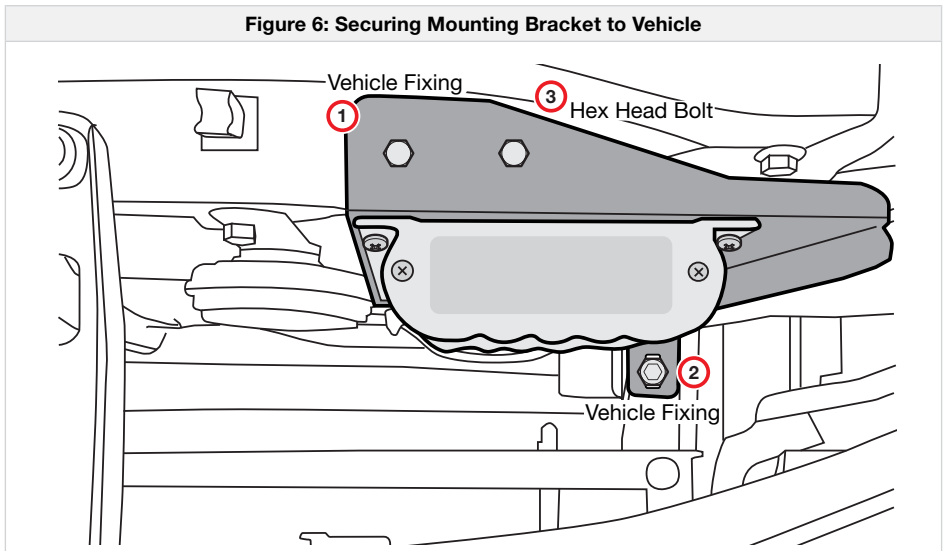

FINALISING INSTALLATION

RE-FITTING THE PLASTIC TRIM

For vehicles with the removed plastic trim, re-fit the modified plastic trim with the two body clips.

COMPLETED INSTALLATION

Once all mounting positions are secured, the installation is complete.

Figure 7: Completed Installation

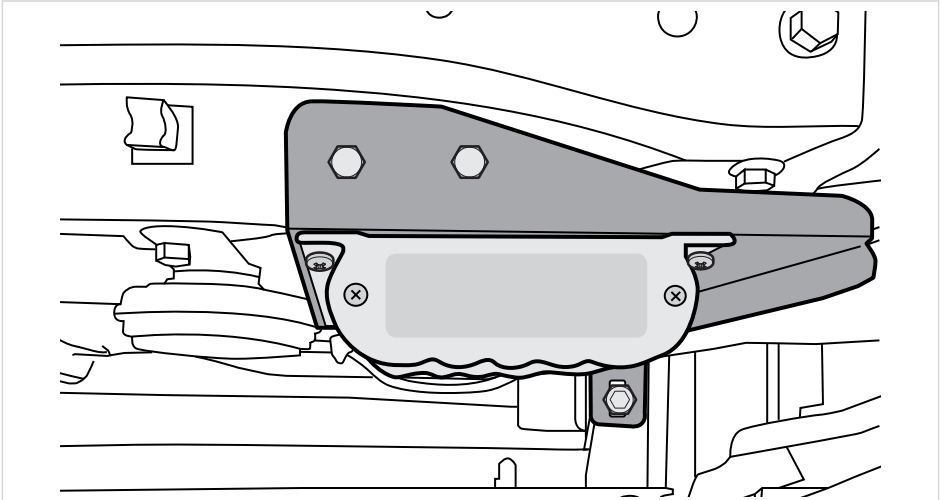

MAINTENANCE

⚠ CAUTION: Ensure the area around the Battery Charger is clean and clear of debris. Any debris not removed will impair the performance of the unit and may cause a fire hazard.

NOTE: Regularly check your vehicle to avoid potential damage to the Battery Charger, your vehicle and batteries (both auxiliary and starter).

WARRANTY

LIMITED WARRANTY

For full warranty terms and conditions, visit the Warranty page of the REDARC website.

www.redarcelectronics.com/warranty

Australia, New Zealand, UK & Europe

REDARC Electronics Pty Ltd
23 Brodie Road (North),
Lonsdale SA 5160
Australia

Australia +61 8 8322 4848
New Zealand +64 9 222 1024
UK & Europe +44 (0)20 3930 8109

North America

REDARC Corporation
c/o Shallico, Inc.
308 Component Dr.
Smithfield, NC 27577
USA

USA +1 (704) 247-5150
Canada +1 (604) 260-5512
Mexico +52 (558) 526-2898

IMPORTER CONTACT INFORMATION

UK

Ozparts UK Ltd
1 Prospect Place
Pride Park
DE24 8HG, Derby
UK

Europe

Ozparts Sp. z o. o. Sp. kom.
Slowackiego 32/5
87-100 Torun
Poland

For written request please email power@redarcelectronics.eu

Tech Support

1300 REDARC (1300-733-272)

Australia

+61 8 8322 4848

New Zealand

+64 9 222 1024

UK & Europe

+44 (0)20 3930 8109

USA

+1 (704) 247-5150

Canada

+1 (604) 260-5512

Mexico

+52 (558) 526-2898

redarcelectronics.com

THE POWER OF

