

THE POWER OF

**REDARC**®

# BCDCMB-108

Mounting Bracket for Selected  
REDARC BCDC Battery Chargers

**SUITABLE FOR TOYOTA LANDCRUISER J100 & J105**

[1998-2007]

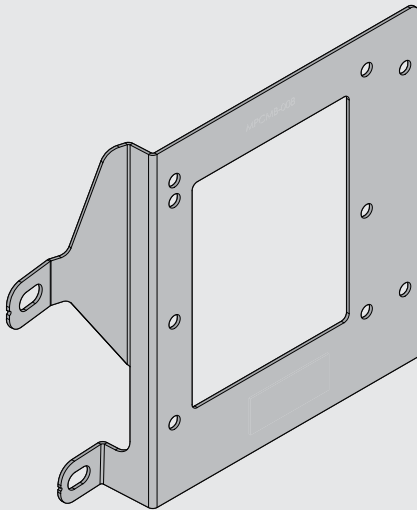

## **BCDC Alpha Mounting Bracket**

**Suitable for TOYOTA LandCruiser**

**J100 & J105** [1998-2007]

The REDARC **BCDCMB-108** Mounting Bracket is designed to install your BCDC Classic/BCDC Alpha Battery Charger\* close to an auxiliary battery mounted in the engine bay. Do not use if the battery is located elsewhere.

For maximum performance, mount your BCDC Classic/BCDC Alpha in the cool airflow at the front of your vehicle, away from high temperature areas.

The BCDC Alpha Mounting Bracket is constructed from durable stainless steel and has been designed to fit existing mounting points in your vehicle for ease of installation.

**\*NOTE:** The BCDC Alpha Mounting Brackets are only for engine bay designed Battery Chargers. DO NOT use the Mounting Bracket to install a BCDC Core Battery Charger (BCDCN1225, BCDCN1240).

# WARNINGS AND SAFETY INFORMATION

**SAVE THESE INSTRUCTIONS** — this manual contains important safety instructions. Do not install the BCDC Alpha Mounting Bracket unless you have read and understood this manual.

REDARC recommends to review your vehicle to ensure this kit suits your vehicle's make and specifications.

REDARC recommends that the BCDC Alpha Mounting Brackets be installed by a suitably qualified person. It is the installers responsibility to ensure their installation complies with any applicable legal and regulatory requirements.

**Disclaimer:** REDARC accepts no liability for any injury, loss or property damage which may occur from the improper or unsafe installation and use of its products.

## SAFETY MESSAGE CONVENTIONS

Safety messages in this manual include a signal word to indicate the level of the hazard as follows:

### ⚠ WARNING

Indicates a potentially hazardous situation which could result in death or serious injury to the operator or to bystanders.

### ⚠ CAUTION

Indicates a potentially hazardous situation which may result in moderate or minor injury to the operator or to bystanders.

### NOTICE

Indicates a situation that may cause equipment damage.

### ⚠ WARNING

- Do not operate around the engine bay with the engine operating. Ensure the vehicle is OFF before mounting Battery Charger assembly.

### ⚠ CAUTION

- Use Personal Protective Equipment (PPE). Wear appropriate clothing as well as eye protection when operating power tools.
- Take care when working in and around engine bay to avoid punch points, sharp edges and hot surfaces.



### NOTICE

- Removing existing vehicle fixings may expose bare metal, resulting in rust. Retouch any exposed metal with rust inhibitor if it is not an earth connection.
- Damage to cabling can cause failure of the Battery Charger and vehicle electrical systems. Ensure wiring is clear of sharp edges and moving parts.

# BCDC ALPHA MOUNTING BRACKET PARTS

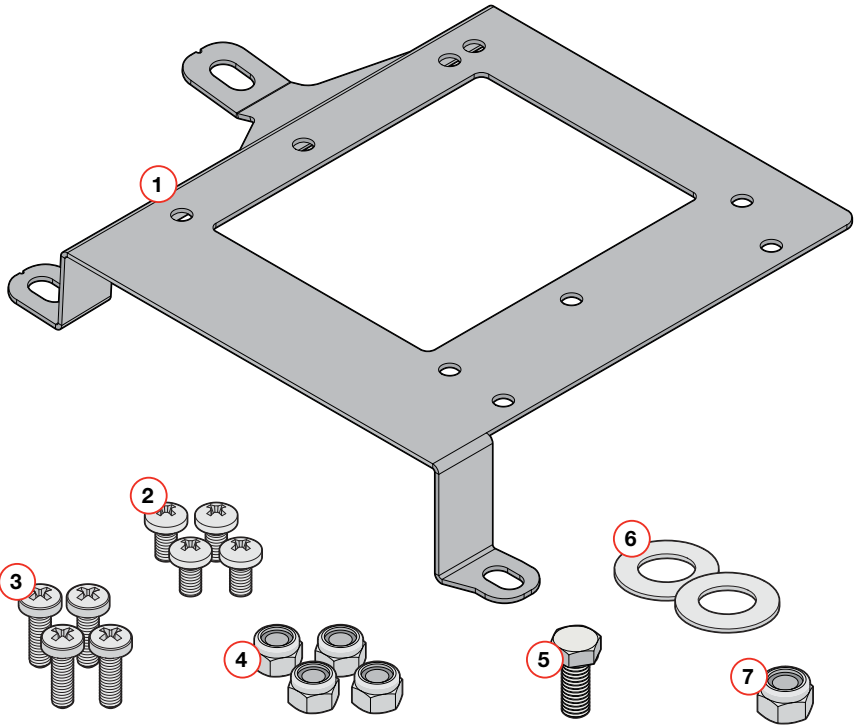

**1. Mounting Bracket**  
Supplied with 1 bracket.

**2. M6 x 12mm Pan Head Bolt**  
Supplied with 4 bolts.

**3. M6 x 20mm Pan Head Bolt**  
Supplied with 4 bolts.

**4. M6 Nyloc Locking Nut**  
Supplied with 4 nuts.

**5. M8 x 20mm Hex Head Bolt\***  
Supplied with 1 bolt.

**6. M8 x 20mm Washer\***  
Supplied with 2 washers.

**7. M8 Nyloc Locking Nut\***  
Supplied with 1 nut.

\*Parts 5, 6 and 7 are only required if the centre radiator support bracket for your vehicle model does not have a lower vehicle support bolt.

## RECOMMENDED TOOLS

The tools listed below are typically sufficient to complete the installation, however, some specific models may require more specialised tools.

- Metric Socket set (at least 10 mm and 12 mm socket) with extension bars.
- Metric Spanner 10mm, 12 mm and 13 mm.
- Medium (#3) Phillips-Head Screwdriver.

# ASSEMBLY

## ASSEMBLING BATTERY CHARGER TO BRACKET

The BCDC Alpha Mounting Bracket must be bolted and fitted to the Battery Charger before mounting to the vehicle. Do not install the BCDC Alpha Mounting Bracket to the vehicle first.

### BCDC Classic Battery Charger

If mounting a BCDC Classic Battery Charger, use the supplied M6 × 12 mm Pan Head Bolts and M6 Nyloc Locking Nuts to secure the Battery Charger to the Mounting Bracket (see Figure 1).

### BCDC Alpha Battery Charger

If mounting a BCDC Alpha Battery Charger, use the supplied M6 × 20 mm Pan Head Bolts and M6 Nyloc Locking Nuts to secure the Battery Charger to the Mounting Bracket (see Figure 2).

Figure 1: BCDC Classic to Mounting Bracket

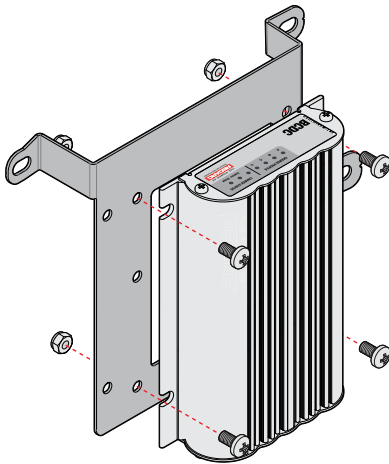

Figure 2: BCDC Alpha to Mounting Bracket

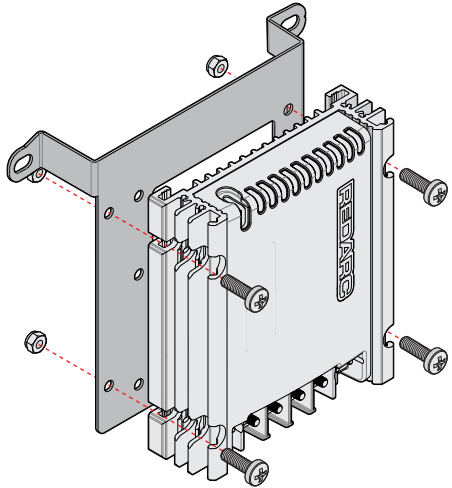
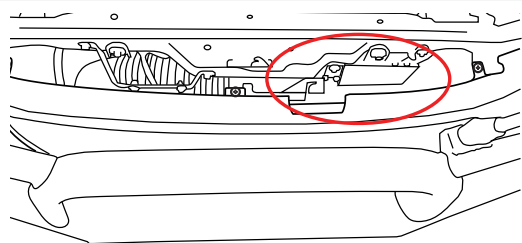

Figure 3: Installation Location



## INSTALLATION LOCATION

The assembled Mounting Bracket and Battery Charger will be mounted to the left side of the vehicle, to the centre radiator support bracket (see Figure 3).

# PRIOR TO INSTALLATION

## GRILLE REMOVAL

**⚠ CAUTION:** Take care when working in and around engine bay to avoid punch points, sharp edges and hot surfaces.

**NOTICE:** Removing existing vehicle fixings may expose bare metal resulting in rust. Retouch any exposed metal with rust inhibitor if it is not an earth connection.

To remove the grille from the vehicle, first unfasten the vehicle fixings from the top of the grille (see [Figure 4](#)). Retain the vehicle fixings for re-fitting the grille after installing the Mounting Bracket assembly.

**Figure 4: Unfastening Phillip Head Screws**

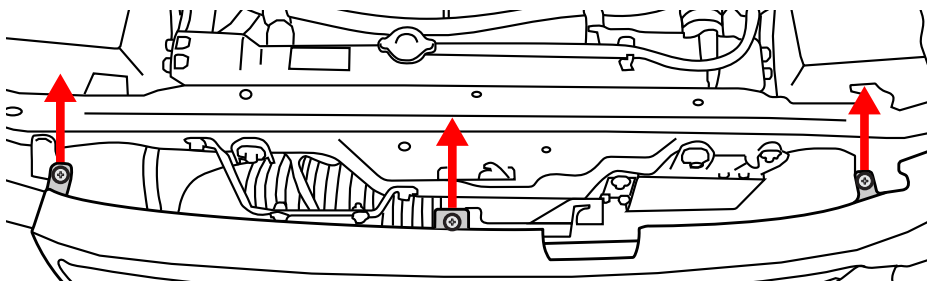

Release the two plastic clips attached to bottom of the grille by pushing the top of the clip towards the front of the vehicle, this will detach the grille (see [Figure 5](#)). Remove the grille away from the vehicle.

**Figure 5: Releasing Plastic Clips**

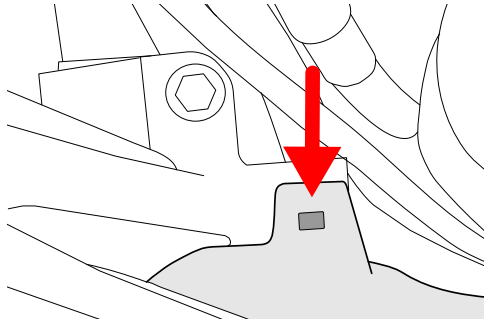

## REMOVING PLASTIC CLIPS

Two additional plastic clips need to be removed from the vehicle prior to installing the Mounting Bracket assembly. These clips are in the grille support brackets attached at the end of each head light mounting. If these clips are already attached to the removed grille, proceed to 'Fitting the Mounting Bracket Assembly to the Vehicle' (page 8).

If the two clips are still attached to the vehicle's grille support panels, adhere to the following:

1. Rotate each clip 90 degrees (see Figure 6).
2. Pull each clip out and away from the vehicle (see Figure 7).
3. Retain the plastic clips for re-fitting the grille after installing the Mounting Bracket assembly.

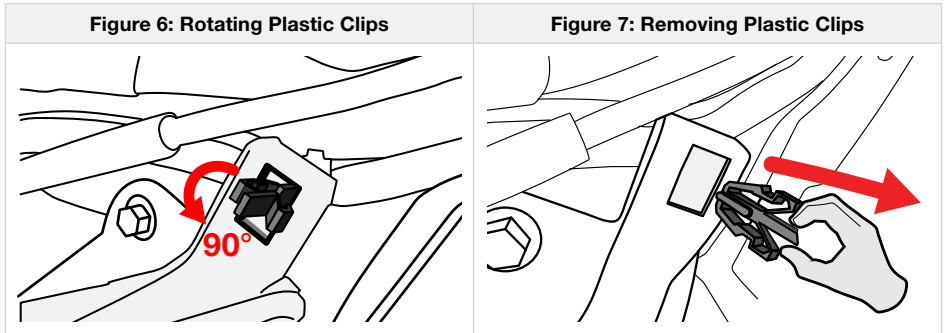

# INSTALLATION

## FITTING THE MOUNTING BRACKET ASSEMBLY TO THE VEHICLE

**⚠ CAUTION:** Take care when working in and around engine bay to avoid punch points, sharp edges and hot surfaces.

**NOTICE:** Removing existing vehicle fixings may expose sharp surfaces and bare metal resulting in rust. Retouch any exposed metal with rust inhibitor if it is not an earth connection.

To fit and secure the Mounting Bracket assembly to the vehicle refer to **Figure 8** and adhere to the following steps:

1. Locate and remove the three vehicle fixings as indicated in **Figure 8 (1) (2) (3)\***.
2. Position the Mounting Bracket assembly in-line with the vehicle fixing holes on the bonnet safety catch and the centre radiator support panel.
3. Secure the Mounting Bracket assembly by re-fitting the three vehicle fixings to their original location\*.

**\*NOTE:** If your vehicle only has one radiator support panel bolt, use the supplied M8 × 20 mm Hex Bolt, M8 × 20 mm Washers and M8 Nyloc Locking Nut to safely secure the Mounting Bracket assembly to the vehicle. Install the first Washer between the Bolt Head and the Mounting Bracket, and the second Washer between the centre radiator support panel and the Nyloc Locking Nut.

4. Tighten the vehicle fixings to the vehicle manufacturers torque specifications and if used, tighten the supplied M8 × 20 Hex Bolt to 15 Nm (11.0 lbf-ft).

**Figure 8: Securing Mounting Bracket to Vehicle**

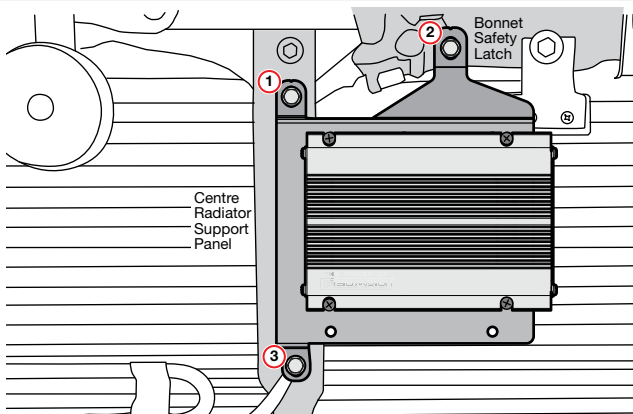



# FINALISING INSTALLATION

## BATTERY CHARGER WIRING

**NOTICE:** Damage to cabling can cause failure to the Battery Charger and the vehicle's electrical system. Ensure wiring is clear of sharp edges, moving parts and has enough slack to allow for flexing.

Once the Mounting Bracket assembly is secured to the vehicle, complete the required wiring in accordance to your Battery Charger's instruction manual.

## RE-FITTING THE GRILLE

Refer to [Figure 9](#) and the following steps to re-fit the grille:

1. Re-attach the two plastic clips that were removed from the grille support brackets ([page 6](#)) to the grille.
2. Aligning the attached plastic clips with the holes in the grille support brackets and clip into place.
3. Fasten the three vehicle fixings to secure the grille to the vehicle. Tighten the screws to the vehicle manufacturers torque specifications.

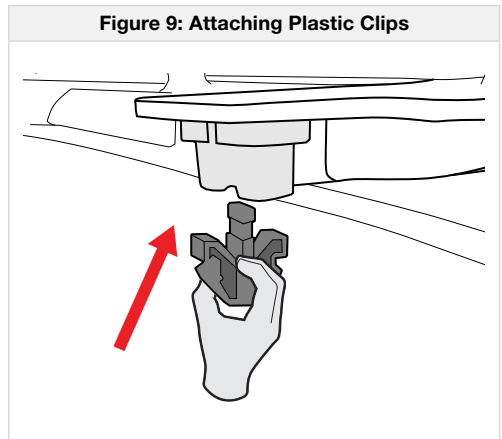

## COMPLETED INSTALLATION

Once the grille is fitted back to the vehicle, the installation is complete.

**Figure 10: Completed Installation**

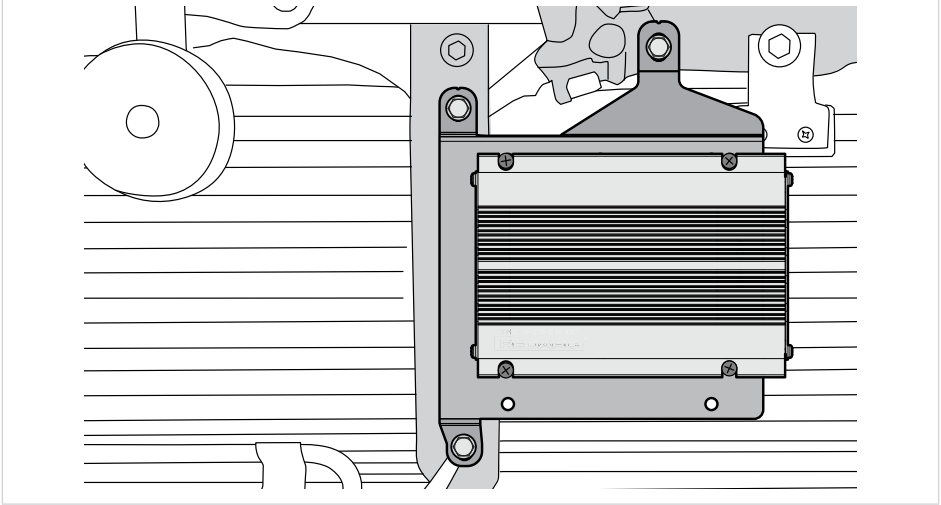

## MAINTENANCE

**⚠ CAUTION:** Ensure the area around the Battery Charger clean and clear of debris. Any debris not removed will impair the performance of the unit and may cause a fire hazard.

**NOTE:** Regularly check your vehicle to avoid potential damage to the Battery Charger, your vehicle, and batteries (both auxiliary and starter).

# WARRANTY

## LIMITED WARRANTY

For full warranty terms and conditions, visit the Warranty page of the REDARC website.

[www.redarcelectronics.com/warranty](http://www.redarcelectronics.com/warranty)

### Australia, New Zealand, UK & Europe

REDARC Electronics Pty Ltd  
23 Brodie Road (North),  
Lonsdale SA 5160  
Australia

**Australia** +61 8 8322 4848  
**New Zealand** +64 9 222 1024  
**UK & Europe** +44 (0)20 3930 8109

### North America

REDARC Corporation  
c/o Shalco, Inc.  
308 Component Dr.  
Smithfield, NC 27577  
USA

**USA** +1 (704) 247-5150  
**Canada** +1 (604) 260-5512  
**Mexico** +52 (558) 526-2898

## IMPORTER CONTACT INFORMATION

### UK

Ozparts UK Ltd  
1 Prospect Place  
Pride Park  
DE24 8HG, Derby  
UK

### Europe

Ozparts Sp. z o. o. Sp. kom.  
Slowackiego 32/5  
87-100 Torun  
Poland

For written request please email [power@redarcelectronics.eu](mailto:power@redarcelectronics.eu)

**Tech Support**

1300 REDARC (1300-733-272)

**Head Office**

+61 8 8322 4848

**New Zealand**

+64 9 222 1024

**UK & Europe**

+44 (0)20 3930 8109

**USA**

+1 (704) 247 5150

**Canada**

+1 (604) 260 5512

**Mexico**

+52 (558) 526-2898

**redarcelectronics.com**

THE POWER OF

**REDARC**®