

THE POWER OF

REDARC®

BCDCMB-110

Mounting Bracket for Selected
REDARC BCDC Battery Chargers

SUITABLE FOR NISSAN PATROL Y61, GU SERIES 4 TO 9 DIESEL

[2005-04/2016]

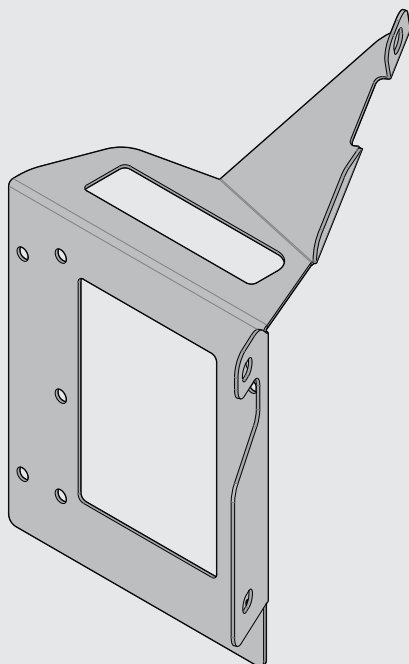

BCDC Alpha Mounting Bracket

Nissan Patrol Y61, GU Series

4 to 9 Diesel (03/2005–09/2015)

The REDARC **BCDCMB-110** Mounting Bracket is designed to install your BCDC Classic/BCDC Alpha Battery Charger* close to an auxiliary battery mounted in the engine bay. Do not use if the battery is located elsewhere.

For maximum performance, mount your BCDC Classic/BCDC Alpha in the cool airflow at the front of your vehicle, away from high temperature areas.

The BCDC Alpha Mounting Bracket is constructed from durable stainless steel and has been designed to fit existing mounting points in your vehicle for ease of installation.

***NOTE:** The BCDC Alpha Mounting Brackets are only for engine bay designed Battery Chargers. DO NOT use the Mounting Bracket to install a BCDC Core Battery Charger (BCDCN1225, BCDCN1240).

WARNINGS AND SAFETY INFORMATION

SAVE THESE INSTRUCTIONS — this manual contains important safety instructions. Do not install the BCDC Alpha Mounting Bracket unless you have read and understood this manual.

REDARC recommends to review your vehicle to ensure this kit suits your vehicle's make and specifications.

REDARC recommends that the BCDC Alpha Mounting Brackets be installed by a suitably qualified person. It is the installers responsibility to ensure their installation complies with any applicable legal and regulatory requirements.

Disclaimer: REDARC accepts no liability for any injury, loss or property damage which may occur from the improper or unsafe installation or use of its products.

SAFETY MESSAGE CONVENTIONS

Safety messages in this manual include a signal word to indicate the level of the hazard as follows:

⚠ WARNING

Indicates a potentially hazardous situation which could result in death or serious injury to the operator or to bystanders.

⚠ CAUTION

Indicates a potentially hazardous situation which may result in moderate or minor injury to the operator or to bystanders.

NOTICE

Indicates a situation that may cause equipment damage.

⚠ WARNING

- Do not operate around the engine bay with the engine operating. Ensure the vehicle is OFF before mounting Battery Charger assembly.

⚠ CAUTION

- Use Personal Protective Equipment (PPE). Wear appropriate clothing as well as eye protection when operating power tools.
- Take care when working in and around engine bay to avoid punch points, sharp edges and hot surfaces.



NOTICE

- Removing existing vehicle fixings may expose bare metal, resulting in rust. Retouch any exposed metal with rust inhibitor if it is not an earth connection.
- Damage to cabling can cause failure of the Battery Charger and vehicle electrical systems. Ensure wiring is clear of sharp edges and moving parts.

BCDC ALPHA MOUNTING BRACKET PARTS

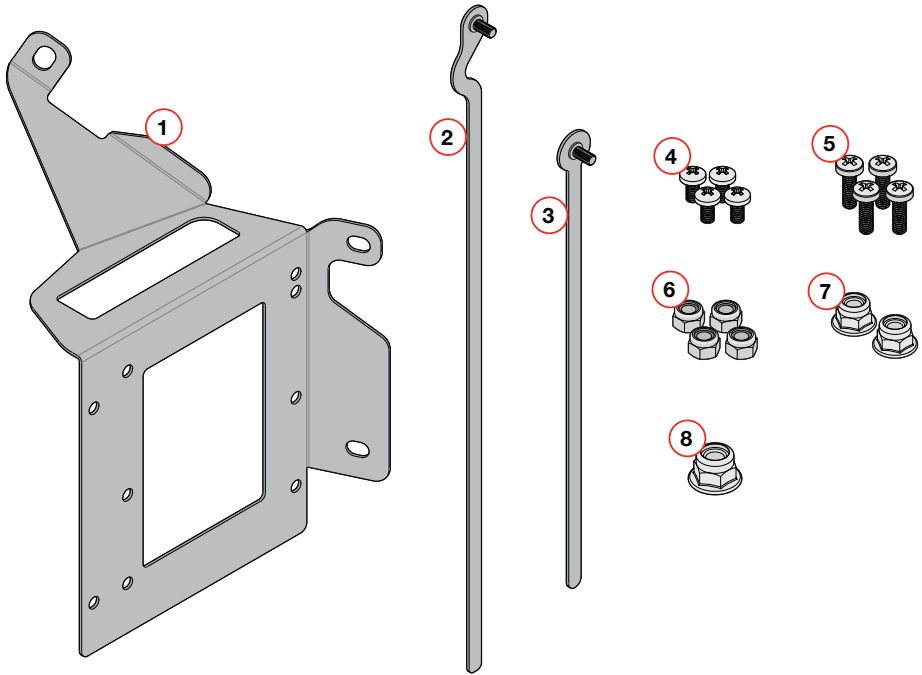

1. Mounting Bracket

2. Long Tag Bolt

3. Short Tag Bolt

4. M6 x 12mm Pan Head Screw

Supplied with 4 screws.

5. M6 x 20mm Pan Head Screw

Supplied with 4 screws.

6. M6 Nyloc Locking Nut

Supplied with 4 nuts.

7. M6 Flanged Nyloc Locking Nut

Supplied with 2 nuts.

8. M8 Flanged Nyloc Locking Nut

Supplied with 1 nut.

RECOMMENDED TOOLS

The tools listed below are typically sufficient to complete the installation, however, some specific models may require more specialised tools.

- Metric Socket set (at least 10 mm, 12 mm and 13 mm socket) with extension bars.
- Metric Spanner 10 mm, 12 mm and 13 mm.
- Medium (#3) Phillips-Head Screwdriver.

ASSEMBLY

ASSEMBLING BATTERY CHARGER TO BRACKET

The BCDC Alpha Mounting Bracket must be fitted to the Battery Charger before mounting to the vehicle. Do not install the BCDC Alpha Mounting Bracket to the vehicle first.

BCDC Classic Battery Charger

If mounting a BCDC Classic, use the supplied M6 × 12 mm Pan Head Bolts and M6 Nyloc Locking Nuts to secure the Battery Charger to the Mounting Bracket as demonstrated in [Figure 1](#).

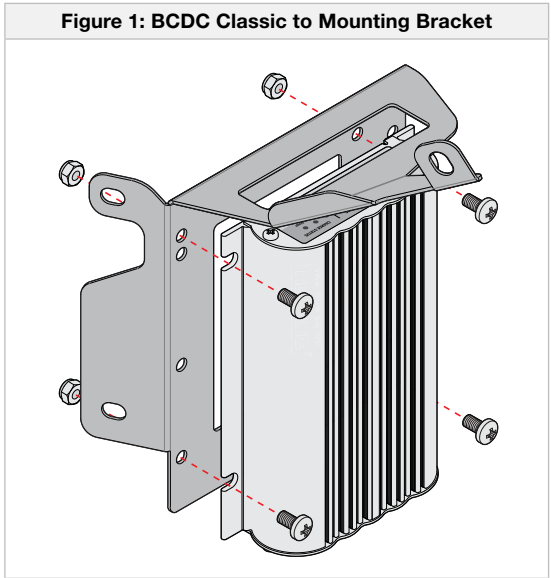

BCDC Alpha Battery Charger

If mounting a BCDC Alpha, use the supplied M6 × 20 mm Pan Head Bolts and M6 Nyloc Locking Nuts to secure the Battery Charger to the Mounting Bracket as demonstrated in [Figure 2](#).

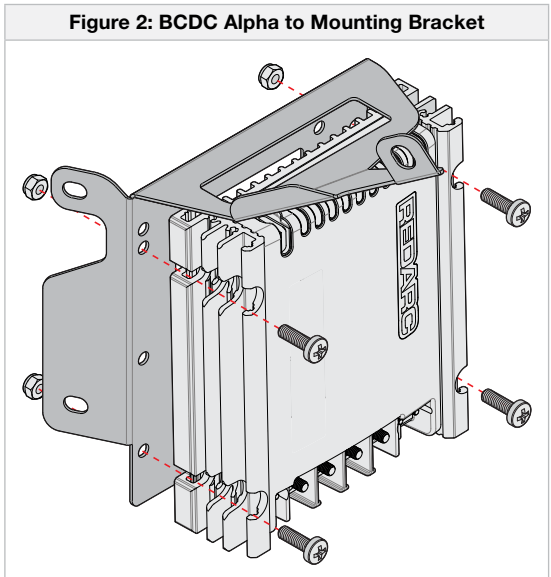

PRIOR TO INSTALLATION

INSTALLATION LOCATION

The assembled Mounting Bracket and Battery Charger will be mounted on the left side of the radiator support panel in the engine bay.

Figure 3: Installation Location

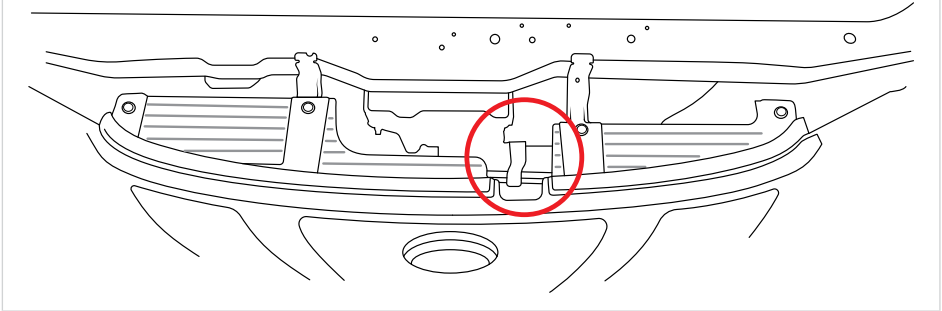

GRILLE REMOVAL

Remove the four clips from the upper plastic shroud. To do this, partially raise the centre pin before pulling upwards. Remove the grille by pulling it towards you.

Retain the four clips for refitment of the grille.

Figure 4: Removing Grille from Vehicle

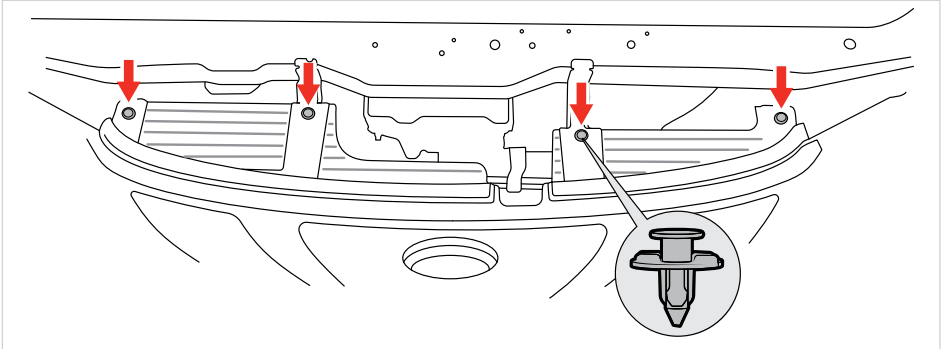

INSTALLATION

BATTERY CHARGER WIRING

NOTICE: Damage to cabling can cause failure to the Battery Charger and the vehicle's electrical system. Ensure wiring is clear of sharp edges, moving parts and has enough slack to allow for flexing.

Fit the Battery Charger with the wiring connected to the bracket before mounting in the vehicle. It is difficult to access the Battery Charger once the bracket is installed.

Complete the required wiring in accordance with your Battery Charger's instruction manual.

FITTING THE MOUNTING BRACKET ASSEMBLY TO THE VEHICLE

To fit the Mounting Bracket to the vehicle refer to [Figure 5](#) and adhere to the following steps:

1. Loosely fit the top of the Bracket assembly to the threaded stud using the supplied M8 Flanged Nylon Locking Nut (1).
2. Loosen the top headlamp vehicle fixing, unscrewing it just enough that the nut remains attached. This is to allow the long tag bolt to pass unobstructed behind the headlamp vehicle fixing when it is inserted (2).

Figure 5: Fitting Mounting Bracket to Vehicle

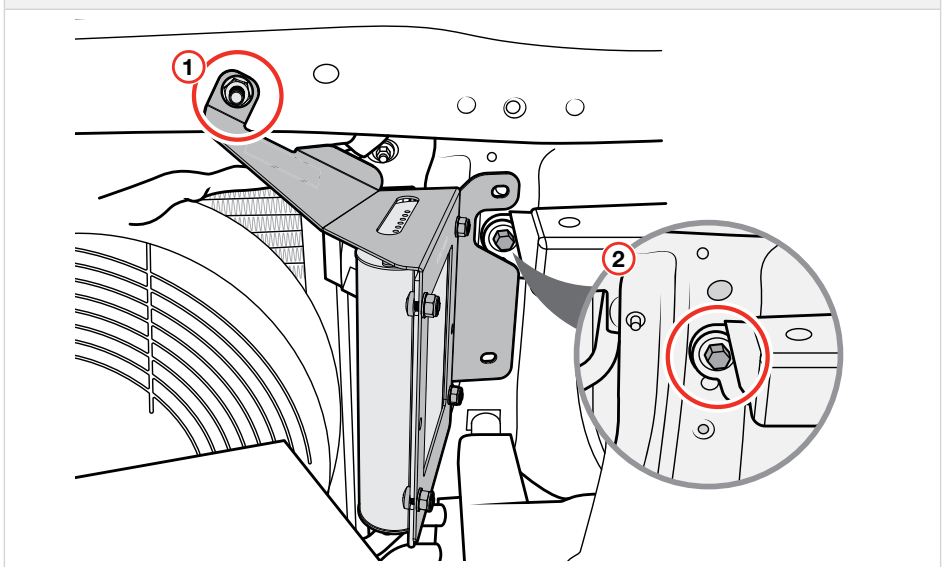

SECURING MOUNTING BRACKET ASSEMBLY TO THE VEHICLE

To secure the Mounting Bracket assembly to the vehicle refer to **Figure 6** and adhere to the following steps:

1. Using the Long Tag Bolt, insert it into the large rectangular hole at the bottom of the support upright **(1)**.

NOTE: The lower section of the Tag Bolt can be bent to make it easier to insert.

2. Feed the threaded end of the tag bolt out through the hole near the top of the support upright, then loosely fit the supplied M6 Flanged Nylon Locking Nut.

NOTE: Once the threaded section of the tag bolt is protruding from the correct hole, hold it in place with a screw driver or similar **(2)**.

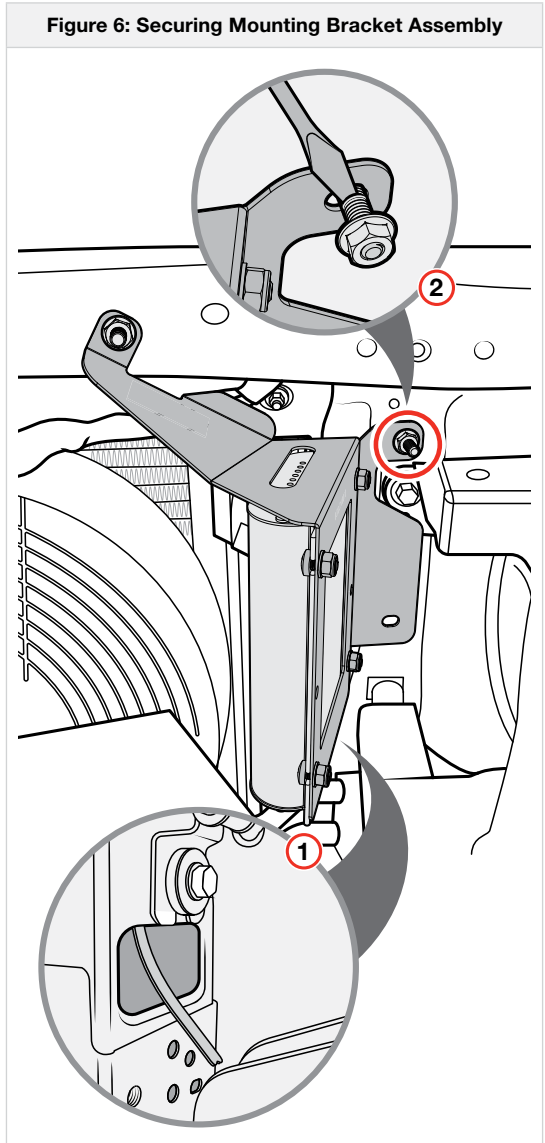

FINALISING INSTALLATION

1. Using the Short Tag Bolt, insert it through the same large rectangular hole as the Long Tag Bolt.
2. Feed the threaded end of the Tag Bolt out through the small rectangular hole in the middle of the support upright, then fit the supplied M6 Flanged Locking Nut (1).
3. Tighten all fasteners, including the loosened headlamp upper nut. Torque vehicle fixings to the vehicles manufacturers torque specifications (2).

Figure 7: Finalising Installation

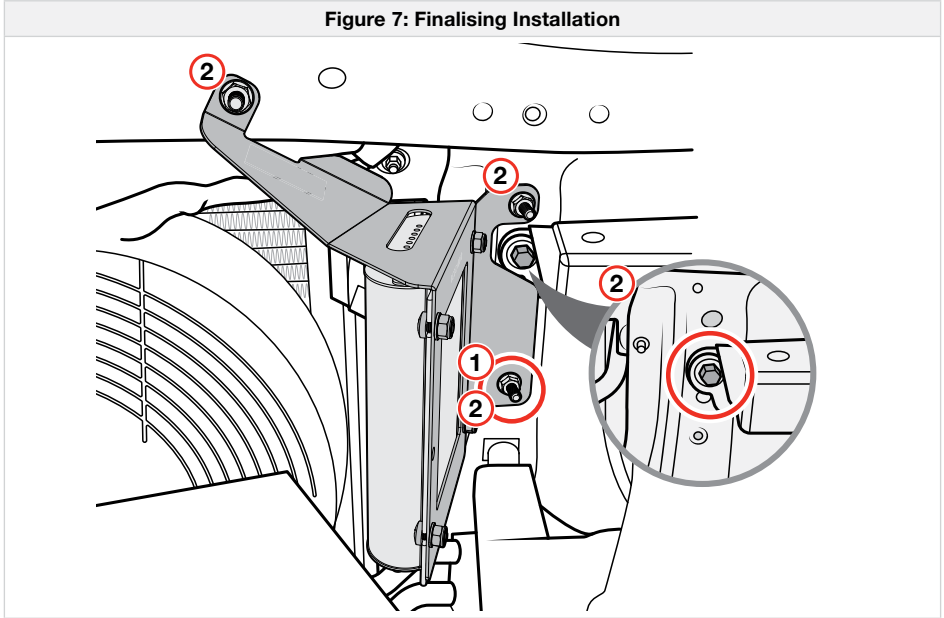

RE-FITTING THE GRILLE

Re-fit the grille and secure with the clips removed during removal. These clips are secured when the centres are flush with the outer edge of the clip.

Figure 8: Fitting Clips to the Grille

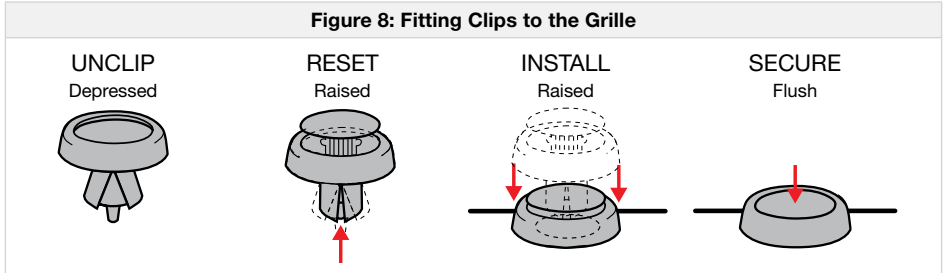

COMPLETED INSTALLATION

Once the grille is fitted back to the vehicle, the installation is complete.

Figure 9: Completed Installation

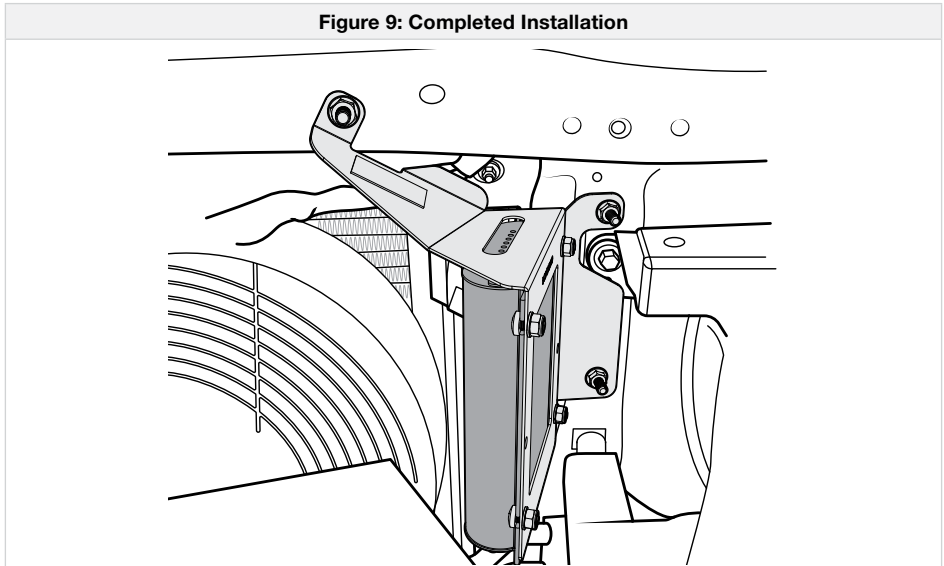

MAINTENANCE

⚠ CAUTION: Ensure the area around the Battery Charger is clean and clear of debris. Any debris not removed will impair the performance of the unit and may cause a fire hazard.

NOTE: Regularly check your vehicle to avoid potential damage to the Battery Charger, your vehicle and batteries (both auxiliary and starter).

WARRANTY

LIMITED WARRANTY

For full warranty terms and conditions, visit the Warranty page of the REDARC website.

www.redarcelectronics.com/warranty

Australia, New Zealand, UK & Europe

REDARC Electronics Pty Ltd
23 Brodie Road (North),
Lonsdale SA 5160
Australia

Australia +61 8 8322 4848
New Zealand +64 9 222 1024
UK & Europe +44 (0)20 3930 8109

North America

REDARC Corporation
c/o Shallico, Inc.
308 Component Dr.
Smithfield, NC 27577
USA

USA +1 (704) 247-5150
Canada +1 (604) 260-5512
Mexico +52 (558) 526-2898

IMPORTER CONTACT INFORMATION

UK

Ozparts UK Ltd
1 Prospect Place
Pride Park
DE24 8HG, Derby
UK

Europe

Ozparts Sp. z o. o. Sp. kom.
Slowackiego 32/5
87-100 Torun
Poland

For written request please email power@redarcelectronics.eu

Tech Support

1300 REDARC (1300-733-272)

Australia

+61 8 8322 4848

New Zealand

+64 9 222 1024

UK & Europe

+44 (0)20 3930 8109

USA

+1 (704) 247-5150

Canada

+1 (604) 260-5512

Mexico

+52 (558) 526-2898

redarcelectronics.com

THE POWER OF

REDARC®