



# ISUZU D-MAX 2012-2017 130Kw Direction-Plus™ Pre-Filter Kit Installation Guide

This document is to be used as a guide for the installation of the Direction-Plus™ Fuel Manager™ FM100 pre-filter Kit to a D-Max 2012-2017. It is recommended that the installation of the product be carried out by a competent qualified mechanic.

## Important before starting

- Ensure the engine bay is clean and free from contaminates
- The fuel manager filter head has direction arrows indicating the direction of flow
- You have the correct tools to complete the fitment
- Read the instructions in full and familiarize yourself with the installation, before commencing any work

## Kit contents

	2
1/4 "NPT STRAIGHT - 12MM 2 BOLTS 2 NUTS 4	1
WASHERS	3
BOLT - 6X25MM ZINC	1
BRACKET - DMAX 130 KW	2
FUEL LINE RUBBER (12MM)	2
1/4 "NPT PLUG	1
SPARE ELEMENT ASSEMBLY 30M - 3.6"	1
FM ENGINE BAY LABEL	1
FM100 30 MICRON FILTER ASSY	2
HOSE CLAMP 12MM	1
LOCTITE 567 THREAD SEALANT - 6ML	2
PUSH ON 90 DEG - 12MM	3
WASHER - 6MM	1
WINDSCREEN LABEL	

Pre-filter mounting location

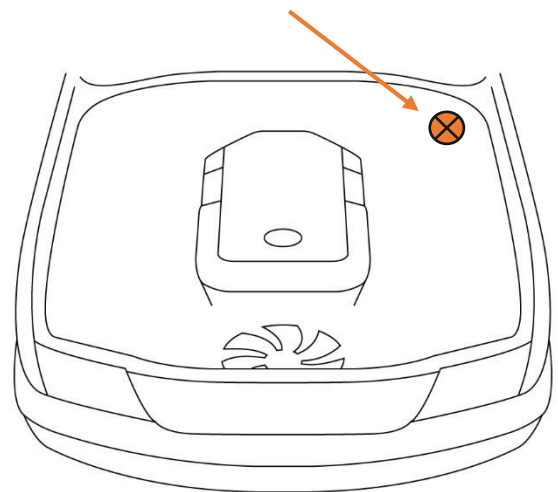

\*Kit contents are subject to change based on component availability and/or refinement

## Fuel Manager Pre-Filter Normal Flow Header Connection

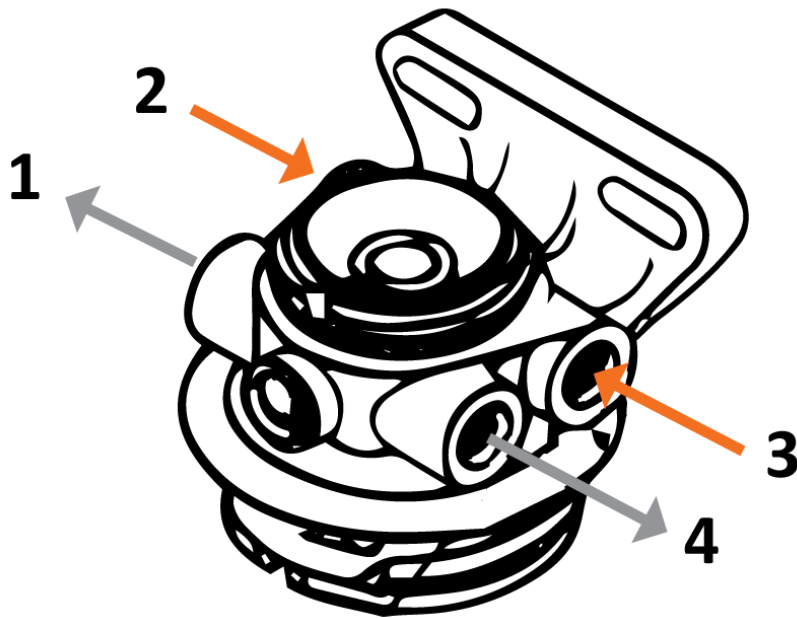

**Ports 2 and 3 = INLET**  
**Ports 1 and 4 = OUTLET**



## **Installation Guide**

1. Remove the 6mm nut from rear corner of the battery tray holding a bracket, also remove the 6mm bolt from the rear of the fuse box.
2. Slide the Direction Plus bracket under the fuse box and over the stud on the battery tray.
3. With supplied 6mm bolts secure the base of the bracket and refit the factory 6mm nut to the battery tray.
4. Using the supplied 10mm bolts, washers and nuts, mount the FM100 Fuel Manager pre-filter assembly filter to the bracket
5. Install the ¼ NPT adaptors into the filter head ports that are closest to the fender using the supplied LOCTITE thread sealant.
6. Lift the factory fuel filter out of the factory mounting bracket and let sit to one side.
7. Identify the hose on the factory fuel filter that is closest to the fender, this is the inlet hose. Trace this hose down to the firewall.
8. Disconnect factory fuel filter inlet hose from both ends and completely remove from the vehicle. Retain this hose in a safe place so the vehicle can be returned to factory in the future
9. Measure from the steel pipe on the firewall (this pipe comes from the tank) to the inlet port of the fuel manager head (the arrows on the head indicate direction of flow) and cut to length a piece of the supplied 12mm hose
10. Lubricate the barbed end of one push-lock fitting and the inside portion of the hose to be fitted with a push-lock fitting with diesel fuel or WD40
11. Insert the barbed end of one push-lock fittings into the pre-lubricated end of the hose. Ensuring that the hose stops firmly against the inside of the bell cover.
12. With the assembled hose, screw the push-lock fitting on to the inlet port of the pre-filter. Connect the other end of the same hose to the steel fuel line coming from the tank and secure using a supplied 12mm hose clamp
13. Lubricate the barbed end of the remaining push-lock fitting and the inside portion of the remaining hose to be fitted with a push-lock fitting with diesel fuel or WD40
14. Insert the barbed end of the remaining push-lock fittings into the pre-lubricated end of the hose. Ensuring that the hose stops firmly against the inside of the bell cover.
15. With the now assembled hose, screw the push-lock fitting on to the outlet port of the pre-filter.



16. Measuring the hose in place between the outlet port of pre-filter the inlet of the factory fuel filter, cut the hose to length
17. Connect the 12mm fuel hose to the inlet of the factory fuel filter and secure with a supplied 12mm hose clamp
18. Refit the factory fuel filter back into its mounting bracket.
19. Apply a small amount of LOCTITE thread sealant to the two black ¼ NPT plugs and install them into the two remaining ports in the pre-filter head.
20. Using the supplied nylon cable ties, secure any loose hose from rubbing on any other components
21. Bleed the fuel system by pumping the hand primer on the factory filter until firm
22. Start vehicle and run the vehicle, whilst checking all connections for leaks

END OF GUIDE