



NISSAN Patrol 3.0 Litre Common Rail and TD42 Direction-Plus™ Pre-Filter Kit Installation Guide

This document is to be used as a guide for the installation of the Direction-Plus™ Fuel Manager™ FM100 pre-filter Kit to a Patrol 3.0L Common Rail and TD42. It is recommended that the installation of the product be carried out by a competent qualified mechanic.

Important before starting

- Ensure the engine bay is clean and free from contaminates
- The fuel manager filter head has direction arrows indicating the direction of flow
- You have the correct tools to complete the fitment
- Read the instructions in full and familiarize yourself with the installation, before commencing any work

Kit contents

	2
M8 1.25 X 40 Z PS SCR	2
1/4" NPT STRAIGHT - 10MM 2 BOLTS 2 NUTS 4 WASHERS	1
6mm Spring Washer	2
8mm Spring Washer	2
BOLT - 6X25MM ZINC	1
BRACKET - PATROL DRIVERS SIDE	2
DFL10 - FUEL LINE RUBBER (10MM)	2
DP733-04 - 1/4 "NPT PLUG	1
ELEMENT ASSEMBLY 30M - 3.6"	1
FM ENGINE BAY LABEL	1
FM100 30 MICRON FILTER ASSY	2
HOSE CLAMP - 10MM	1
LOCTITE 567 THREAD SEALANT - 6ML	2
PUSH ON 90 DEG - 10MM	2
WASHER - 6MM	1
WINDSCREEN LABEL	

Pre-filter mounting location

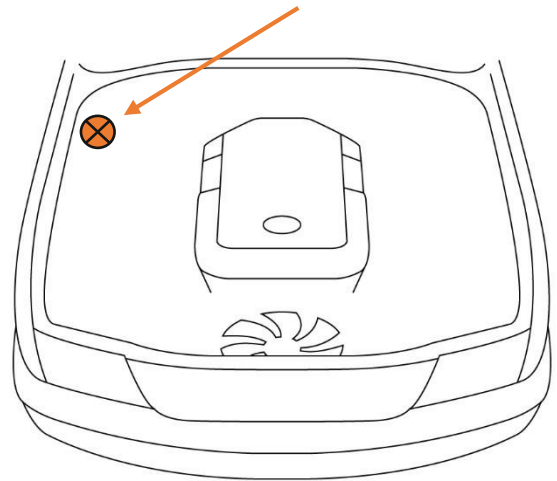

*Kit contents are subject to change based on component availability and/or refinement

Fuel Manager Pre-Filter Normal Flow Header Connection

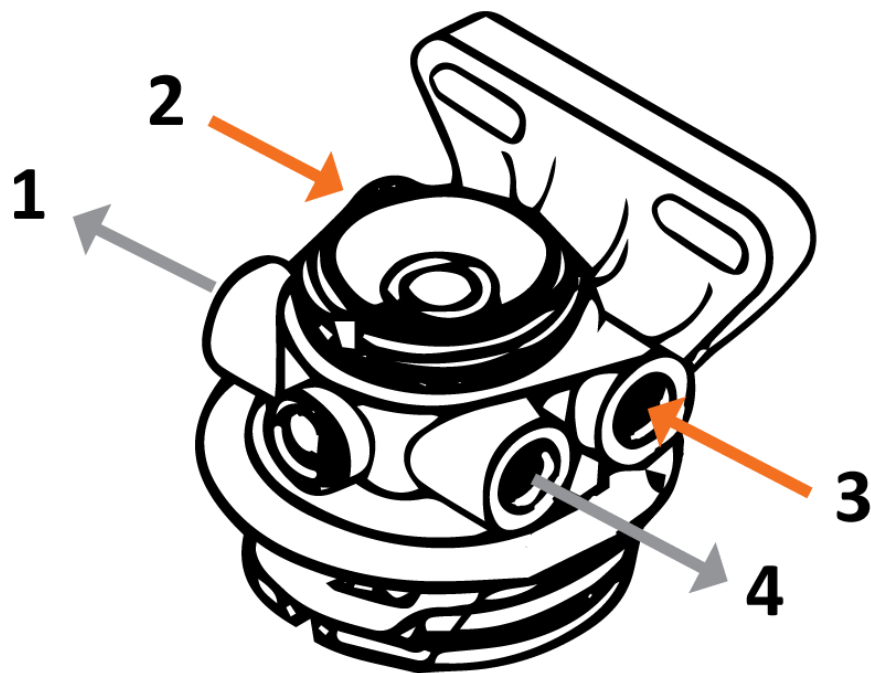

Ports 2 and 3 = INLET
Ports 1 and 4 = OUTLET



Installation Guide

1. The Direction Plus bracket mounts on the driver's side inner mudguard (see image). Use the two (2) 8mm bolts and two (2) 6mm bolts supplied. On some vehicle's there may be a solenoid mounted in this position, this will now remount on the supplied bracket.
2. Secure the Direction Plus bracket on to the inner guard and ensure the gas bonnet strut clears the new bracket. Mount the Direction Plus Pre-Filter to the bracket using the supplied bolts, nuts and washers.
3. Ensuring you have a push-lock barb fitting (supplied) on the INLET and OUTLET side, install the ¼ NPT barb fittings into the Direction Plus filter assembly using the supplied LOCTITE thread sealant.
4. Completely remove the factory flexible fuel hose from the INLET side of the original filter. Using the supplied fuel hose (ensuring NOT to kink the hose). Connect one (1) end of the fuel hose to the factory steel fuel line, secure using the supplied hose clamp.
5. Lubricate the barbed end of one (1) of the push-lock fittings and the inside portion of the hose to be fitted with a push-lock fitting with diesel fuel or WD40.
6. Insert the barbed end of one (1) of the push-lock fittings into the pre-lubricated end of the hose. Ensuring that the hose is firmly stopped against the inside of the bell cover.
7. Fit the supplied fuel line to the INLET side of the factory final filter and to the OUTLET side of the Direction Plus Pre-Filter assembly.
8. Fit the original/ factory supply fuel line in to the INLET port of the Direction Plus Pre-Filter.
9. Reconnect outlet pipe of the factory filter to the inlet of the common rail supply pump.
10. Apply a small amount of LOCTITE thread sealant (supplied) to the two (2) remaining black ¼ NPT plugs and install them in to the two (2) remaining ports on the Direction Plus pre-filter head assembly.
11. Ensure all fuel lines are suitably secured.
12. Using the supplied nylon cable ties, secure any loose hose to prevent it from rubbing against any other components.
13. Remove the Direction Plus Pre-Filter from the head unit (by unlocking the black lock collar). Fill the filter with CLEAN diesel. Refit the filter ensuring the Fuel Manager logo is under the thumb screw in the mounting head. Refit the lock ring and tighten until it clicks into place. The system is now ready to prime and start.
14. Start and run the engine whilst checking ALL connections for leaks.

END OF GUIDE